



Randolph Avenue, London, W9 1BG

£2,299



BRAITHWAIT



1 x  1 x  1 x 

A spacious 618sq ft one bedroom flat situated within the white stucco period terraces of Randolph Avenue close to Clifton Road benefitting from a lift. The generous proportioned reception measuring 16'8" in length and faces south whilst the separate galley kitchen also faces south. The double bedroom is situated to the back of the building and is similar in size to the reception with ample built-in wardrobes, and with neutral tiled bathroom. Other benefits include very close proximity to the cafes and shops of Clifton Road and 5 minutes walk to Warwick Avenue tube and the picturesque canals of Little Venice.



Randolph Avenue, London, W9
Approximate Gross Internal Area
620 sq ft - 57.59 sq m

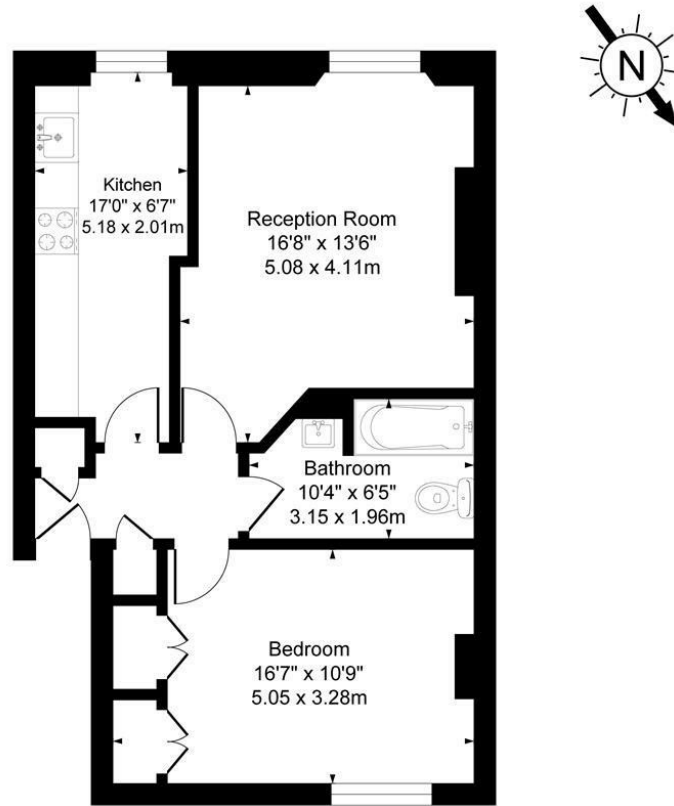

Third Floor

Illustration for identification purposes only, not in scale

Important Notice Debussy Property Service Ltd trading as Braithwait for themselves and for the vendor of this property whose agents they are, give notice that (i) these particulars do not constitute any part of an offer or contract, (ii) all statements contained within these particulars are made without responsibility on the part of Braithwait or the vendor, (iii) whilst none in good faith, none of the statements contained within these particulars are to be relied upon as a statement of representation or fact, (iv) any intending purchaser must satisfy him/herself by inspection or otherwise as to the correctness of each of the statements contained within these particulars, (v) the vendor does not make or give either Braithwait or any person within their employment any authority to make or give any representation or warranty whatsoever in relation to this property. Wide angled lenses may be used in photographs.

Call us on 0207 289 8889 or email sales@braithwait.co.uk

